

MASTER BATH MAKEOVER

By Michael O'Brien

Space in this master bath plan was very tight and offered very few of the spa-like amenities that home buyers are seeking. Pushing the bath's entrance into the hallway and replacing a tub that has a very large deck gives the room a significant increase in usable area. A large and luxurious glass-enclosed shower is now the focal point of the room, and there is still enough space for a good-sized tub. His-and-hers vanities (and a special makeup area for her) provide additional touches of luxury that buyers crave. **PR**

Michael O'Brien is the owner of Change Design, based in Wilmette, Ill. He is an architect who specializes in kitchen design, space planning, and cabinetmaking, with more than 20 years experience working in the high-end custom residential market. To contact Mike, email him at mike@changedesigngroup.net.

This article originally appeared in our sister publication, Professional Builder.

WELLBORN
CABINET, INC.
The Essence of Cabinetry

THIS SECTION IS SPONSORED BY WELLBORN CABINETS

ORIGINAL BATH

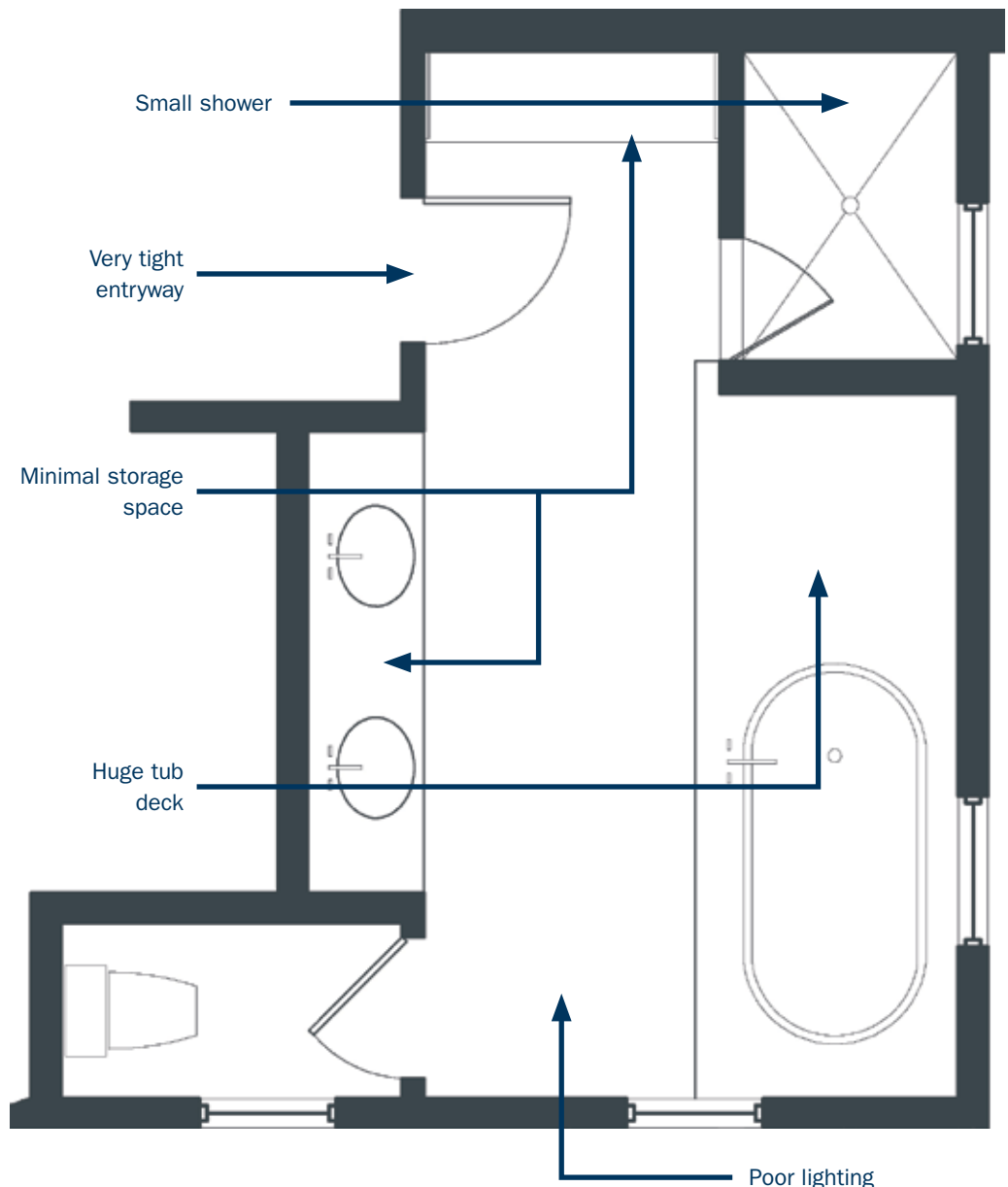

Expanding this bath just enough for an upscale shower, deep tub, more storage, and separate his-and-her vanities provides the spa-like atmosphere homebuyers want.

NEW BATH

